

## ECLIPSE TORQUE WRENCHES RATCHET HEAD

### Torque Mechanism

Accuracy of +/- 3% exceeds all international standards for torque wrenches. Each wrench is supplied with a traceable calibration certificate

### Ratchet

- **Strength & Durability:** push-through ratchet with 60-72 engagements per revolution (depending on the model)
- **Versatility:** push through square drive allows the wrench to be used for torque control in both a clockwise and an anti-clockwise direction (note: ETW14-20 and ETW38-50 are with reversible ratchets so do not have this feature)

### Handle

- **Comfort & Safety:** two component ergonomic handle for maximum comfort and slip resistance
- **Durability:** Handle material and lens resist chemicals in common usage in the automotive, aviation and industrial environments

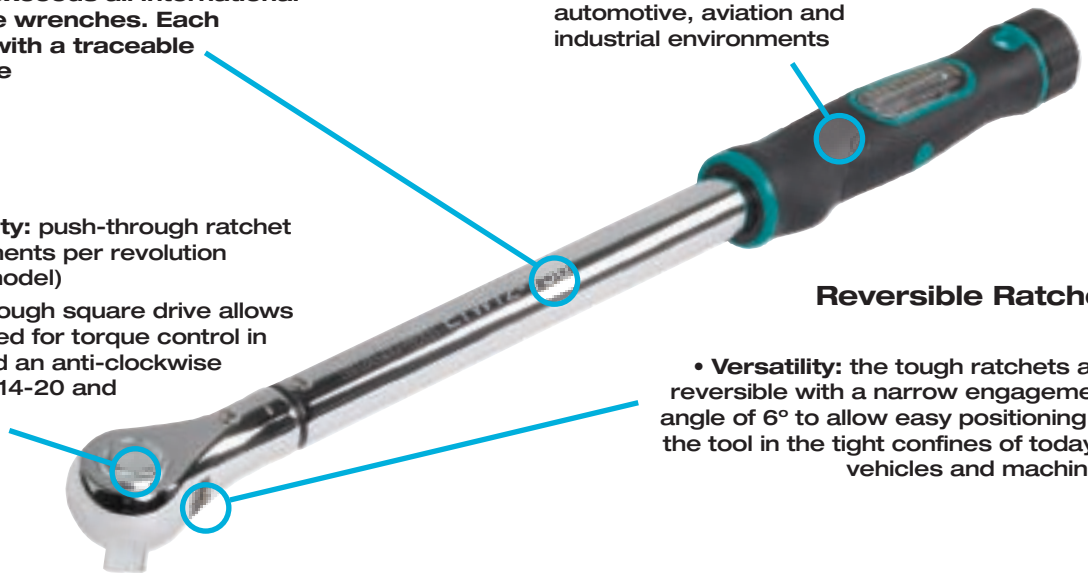

### Reversible Ratchet

- **Versatility:** the tough ratchets are reversible with a narrow engagement angle of 6° to allow easy positioning of the tool in the tight confines of today's vehicles and machines

### Micrometer Scale

**Versatility & Accuracy:** micrometer scale gives simple and error free setting (On dual scale wrenches, the micrometer increment applies to the N.m scale)



### Adjustment Mechanism

**Safety:** a robust lock prevents accidental adjustment of the wrench during use.

**Speed and Ease of Use:** quick and light adjustment with the minimal of effort over the entire scale in approximately ten complete turns.



Part No.	Square Drive Inch	Range N.m	Range lbf.ft	Resolution N.m	Ratchet Diameter mm	Engagements per Revolution	Length mm	Weight kg
ETW14-20	1/4"	1-20	10-180*	0.05	30	72	230	0.4
ETW38-50	3/8"	8-50	6-35	0.10	30	72	230	0.4
ETW38-100	3/8"	20-100	15-75	0.50	38	60	405	1.0
ETW12-100	1/2"	20-100	15-75	0.50	38	60	405	1.0
ETW12-150	1/2"	30-150	20-110	0.50	38	60	455	1.1
ETW12-200	1/2"	40-200	30-150	1.00	46	60	505	1.2
ETW12-250	1/2"	50-250	40-185	1.00	46	60	560	1.4
ETW12-300	1/2"	60-300	45-220	1.00	46	60	610	1.6

\*lbf.in

## ECLIPSE TORQUE WRENCHES FIXED HEAD

### Torque Mechanism

Accuracy of +/- 3% exceeds all international standards for torque wrenches. Each wrench is supplied with a traceable calibration certificate

### Handle

- **Comfort & Safety:** two component ergonomic handle for maximum comfort and slip resistance
- **Durability:** Handle material and lens resist chemicals in common usage in the automotive, aviation and industrial environments

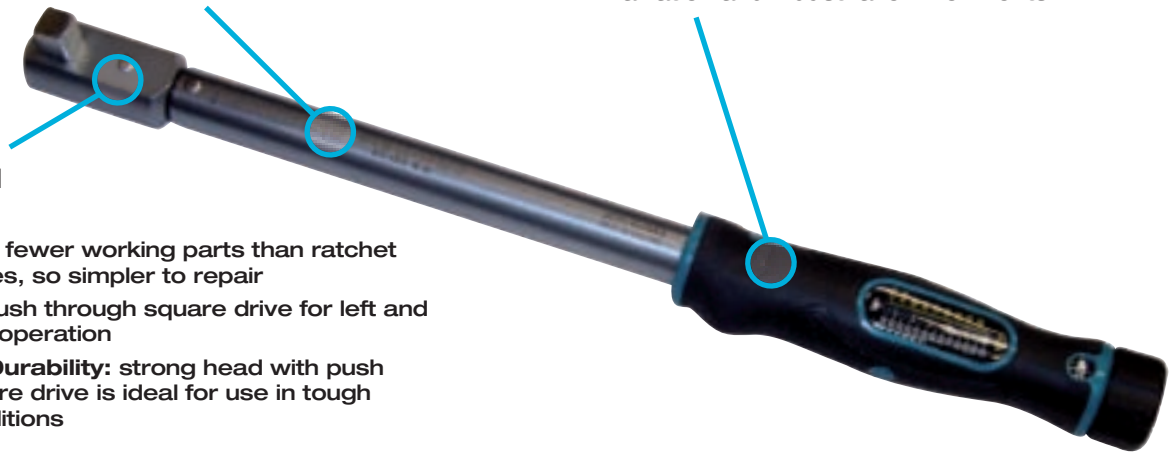

### Fixed Head

- **Ease of use:** fewer working parts than ratchet type wrenches, so simpler to repair
- **Versatility:** push through square drive for left and right handed operation
- **Strength & Durability:** strong head with push through square drive is ideal for use in tough working conditions

### Micrometer Scale

**Versatility & Accuracy:** micrometer scale gives simple and error free setting (On dual scale wrenches, the micrometer increment applies to the N.m scale)



### Adjustment Mechanism

**Safety:** a robust lock prevents accidental adjustment of the wrench during use.

**Speed and Ease of Use:** quick and light adjustment with the minimal of effort over the entire scale in approximately ten complete turns.



Part No.	Square Drive	Range	Range
	Inch	N.m	lbf.ft
ETW38-50FH	3/8"	8-50	6-35
ETW38-100FH	3/8"	20-100	15-75
ETW12-100FH	1/2"	20-100	15-75
ETW12-150FH	1/2"	30-150	20-110
ETW12-200FH	1/2"	40-200	30-150
ETW12-250FH	1/2"	50-250	40-185
ETW12-300FH	1/2"	60-300	45-220

## ECLIPSE PROFESSIONAL TORQUE WRENCHES RATCHET HEAD

### Ratchet

- **Strength & Durability:** push-through ratchet with 60-72 engagements per revolution (depending on the model)
- **Versatility:** push through square drive allows the wrench to be used for torque control in both a clockwise and an anti-clockwise direction
- **Accuracy:** offset ratchet pawls give a narrow engagement angle

### Adjustment Lock

- **Safety:** a robust lock prevents accidental adjustment of the wrench during use.
- **Ease of use:** Fingertip light adjustment



### Handle

- **Comfort & Safety:** two component ergonomic handle for maximum comfort and slip resistance
- **Durability:** Handle material and lens resist chemicals in common usage in the automotive, aviation and industrial environments



### Torque Scale

- **Versatility & Accuracy:** Unique 'harmonic drive' scale mechanism allows for a long scale length and therefore accurate and error free setting

### Torque Mechanism

- **Accuracy:** less parts to maintain when compared to 'pivot block' mechanisms
  - **Accuracy:** +/-3% exceeds all international standards for torque wrenches. Each wrench is supplied with a traceable calibration certificate
  - **Ease of use:** Simple calibration adjustments without disassembly



Part No.	Square Drive Inch	Range N.m	Range lbf.ft	Ratchet Diameter mm	Engagements per Revolution	Length mm	Weight kg
EPTW38-60	3/8"	8-60	5-45	35	72	312	0.66
EPTW12-60	1/2"	8-60	5-45	40	72	320	0.74
EPTW38-100	3/8"	20-100	15-80	35	72	353	0.73
EPTW12-100	1/2"	20-100	15-80	40	72	359	0.80
EPTW12-200	1/2"	40-200	30-150	42	72	442	1.01
EPTW12-300	1/2"	60-300	45-220	49	60	570	1.38
EPTW12-330	1/2"	60-330	45-250	49	60	683	1.50
EPTW34-400	3/4"	80-400	60-300	49	60	683	2.09



**ECLIPSE PROFESSIONAL TORQUE HANDLES (FEMALE FITTING)\***

- For many applications a spanner end fitting rather than a socket is the best or, often, the only solution. Typically this will be because the joint is a pipe union (such as a brake pipe)
- 9x12mm and 14 x 18mm rectangular type handles



Part No.	Square Drive	Range	Range	Length	Weight
	Inch	N.m	lbf.ft	mm	kg
EFTH-60	9x12	8-60	5-45	300	0.55
EFTH-100	9x12	20-100	15-80	340	0.6
EFTH12-200	9x12	40-200	30-150	421	0.78
EFTH18-200	14x18	40-200	30-150	431	0.78
EFTH-300	14x18	60-300	45-220	546.5	1.13
EFTH-400	14x18	80-400	60-300	658	1.78

\*Available on request. Minimum order quantities apply

**ECLIPSE AUTOMOTIVE TORQUE WRENCHES (RATCHET HEAD)\***

- **Versatility:** The reversible ratchet is designed with compact dimensions and a narrow engagement angle resulting from the 72 tooth pattern. This makes the wrench ideal for use in the confined spaces of modern motor vehicles and other applications where space is limited
- **Accuracy:** of +/- 3% exceeds all international standards for torque wrenches. Each wrench is supplied with a traceable calibration certificate
- **Comfort & Safety:** two component ergonomic handle for maximum comfort and slip resistance
- **Durability:** Handle material and lens resist chemicals in common usage in the automotive, aviation and industrial environments
- **Safety:** a robust lock prevents accidental adjustment of the wrench during use



Part No.	Square Drive	Range	Range	Ratchet Diameter	Engagements per Revolution	Length	Weight
	Inch	N.m	lbf.ft	mm		mm	kg
EATW38-60	3/8"	8-60	5-45	31	72	307	0.6
EATW12-60	1/2"	8-60	5-45	31	72	307	0.6
EATW38-100	3/8"	20-100	15-80	31	72	347	0.7
EATW12-100	1/2"	20-100	15-80	31	72	347	0.7
EATW12-200	1/2"	40-200	30-150	41	72	443	1.0

\*Available on request. Minimum order quantities apply

## ECLIPSE INDUSTRIAL TORQUE WRENCHES

- **Accuracy:** +/-4%, even in arduous working conditions. Each wrench is supplied with a traceable calibration certificate
- **Accuracy:** large break angle improves accuracy by reducing the possibility of over torquing
- **Safety:** cam control of the mechanism gives a controlled break which will not throw the operator off balance
- **Versatility:** dual scaled – N.m and lbf.ft



Part No.	Square Drive Inch	Range N.m	Range lbf.ft	Ratchet Diameter mm	Engagements per Revolution	Length mm	Weight kg
EITW-500	3/4"	100-500	70-350	70	36	910	5.2
EITW-1000	3/4"	300-1000	200-750	70	36	1475	7.3
EITW-1500	3/4"	70-1500	500-1000	70	36	1475	10.4

**ECLIPSE PROFESSIONAL INDUSTRIAL TORQUE WRENCHES  
RATCHET HEAD**

- **Accuracy:** +/- 3% reading
- **Ease of Use:** non length dependent - extension handle can be used to reduce operator effort (handle supplied as standard with 800, 1000 and 1500 N.m models)
- **Accuracy:** long scale length in N.m and lbf.ft allows error free setting
- **Versatility:** fine 60 tooth ratchet allows the wrench to be used in confined spaces
- **Ease of Use:** positive 'click' can be heard, seen and felt
- **Storage & Protection:** supplied in hard carry case

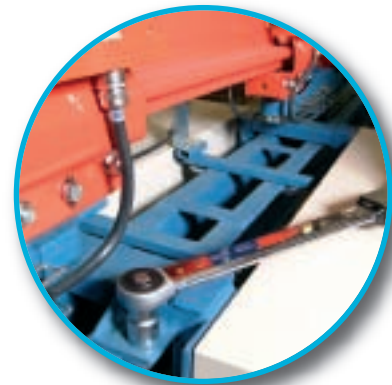

Part No.	Square Drive Inch	Range N.m	Range lbf.ft	Ratchet Diameter mm	Engagements per Revolution	Length mm	Length (Inc Ext Handle) mm	Weight kg
EPITW34-550	3/4"	110-550	80-400	61	60	845	-	4.0
EPITW34-800	3/4"	200-800	150-600	75	60	1035	1535	5.2
EPITW1-800	1"	200-800	150-600	75	60	1035	1535	5.2
EPITW34-1000	3/4"	300-1000	220-750	75	60	1250	1750	5.8
EPITW1-1000	1"	300-1000	220-750	75	60	1250	1750	5.8
EPITW34-1500	3/4"	500-1500	370-1100	75	60	1570	2070	6.7
EPITW1-1500	1"	500-1500	370-1100	75	60	1570	2070	6.7

## RATCHET REPAIR KITS

### Eclipse Range

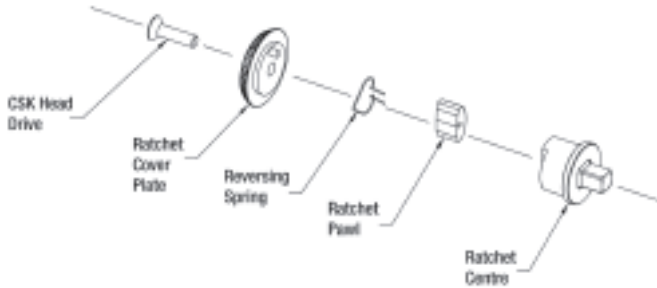

Part No	For Torque Wrenches	Box Qty
E13425	ETW14-20	1
E13426	ETW-38-50	1

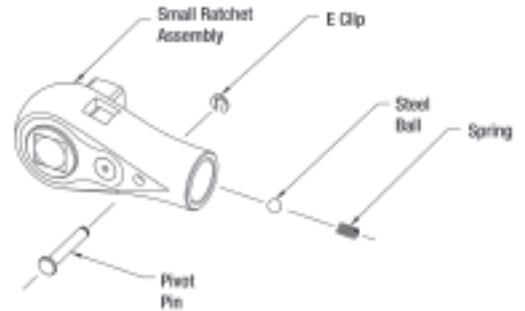

Part No	For Torque Wrenches	Box Qty
E13427	ETW1/2-50	1
E13407	ETW38-100	1
E13409	ETW12-100 / ETW12-150	1
E13408	ETW12-200 / ETW12-250 / ETW12-300	1

### Eclipse Professional Range

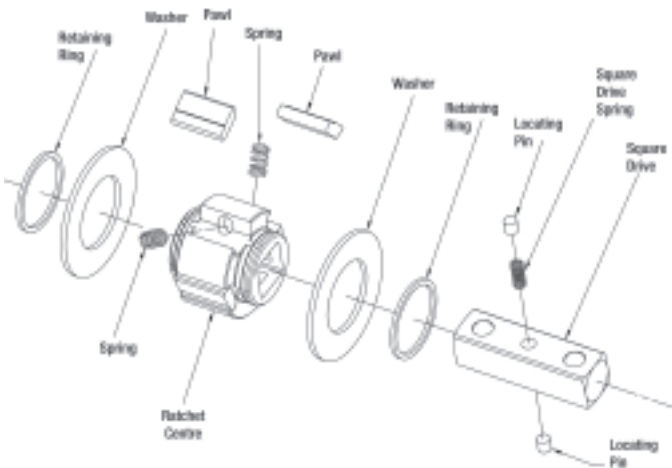

Part No	For Torque Wrenches	Box Qty
E13212	EPTW38-60 / EPTW38-100	1
E13213	EPTW12-60 / EPTW12-100	1
E13214	EPTW12-200	1
E13215	EPTW12-300 / EPTW12-330	1
E13216	EPTW34-400	1

### Eclipse Automotive Professional Range

#### Assembled Ratchet Head

Part No	For Torque Wrenches	Box Qty
E11598	EATW38-60 / EATW38-100	1
E11618	EATW12-60 / ETW12-100	1
E11622	EATW12-200	1

### Eclipse Industrial Range

#### Ratchet Repair Kit

Part No	For Torque Wrenches	Box Qty
E12307	EITW-500 / EITW-800 / EITW-1000 / EITW-1500	1

#### Kit contains

Description	Qty
Ratchet Centre	1
Side Washers	2
Circlips	2
Pawls	4
Springs	4



**ECLIPSE TORQUE SCREWDRIVERS**



Bit holder can be removed and replaced with a wide range of screwdriver blades



Part No.	Hex Holder Size	Range N.m	Length mm	Weight kg
ETS14-15	1/4"	0.3 - 1.5	155	0.235
ETS14-30	1/4"	0.6 - 3.0	155	0.235
ETS14-60	1/4"	1.2 - 6.0	155	0.235